

DM001-26 Frozen Drink Maker

User Manual

SKU: DM001-26BL-USEH

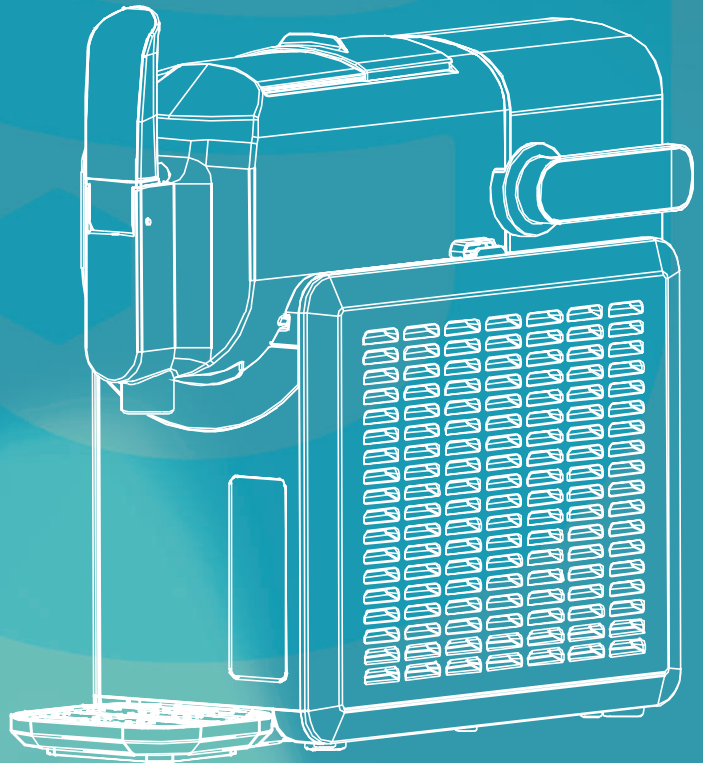

THANK YOU

for purchasing the Euhomy ice maker



Scan the QR code using a mobile device

ACTIVATE YOUR WARRANTY

<https://euhomy.com/pages/activate-warranty>



RECORD THIS INFORMATION

Model Number ISM2621D

Serial Number _____

Date of Purchase _____

Store of Purchase _____

(Keep receipt)

TIP

Check the back or side of the machine for the serial number on the nameplate.

For car refrigerators, it's usually on the bottom or side. If you can't find it, don't worry — it won't affect your warranty registration.

CUSTOMER SERVICE



1-833-362-2655



support@euhomy.com



<https://euhomy.com>

JOIN US



euhomyofficial



EuhomyOfficial



euhomy_us



euhomy



SCAN HERE to share tips, get support, and connect with fellow enthusiasts!







Contents

Important Safety Instructions	01
Key Components And Structure	05
Control And Display Panel	06
Presets	08
Before First Use	08
How To Use	09
Operate The Frozen Drink Maker	10
Clean & Disassembly	13
Recip	15
Troubleshooting	19
Specifications	20

IMPORTANT SAFETY INSTRUCTIONS

INDOOR HOUSEHOLD USE ONLY. READ ALL INSTRUCTIONS BEFORE USE

-  Read and review instructions to understand the operation and use of the product.
-  Indicates the presence of a hazard that can cause personal injury, death, or substantial property damage if the warning included with this symbol is ignored.
-  Avoid contact with hot surfaces. Always use hand protection to avoid burns.
-  For indoor and household use only.

WARNINGS

1. Read all instructions before using the appliance and its accessories.
2. Carefully follow all warnings and instructions. This unit contains electrical connections and moving parts that may present a risk to the user.
3. Take inventory of all parts to ensure you have everything needed to safely operate the appliance.
4. Turn the appliance **OFF** and unplug it from the outlet when not in use, before assembling or disassembling parts, and before cleaning. To unplug, grasp the plug by its body and pull from the outlet. **NEVER** pull the flexible cord to unplug.
5. Before use, wash all parts that may come into contact with food, following the washing instructions in this manual.
6. **DO NOT** operate the appliance with a damaged cord or plug or after it malfunctions, is dropped, or is damaged in any way.
7. This appliance has important markings on the plug. The entire supply cord is not replaceable. If the cord is damaged, the appliance should be discarded.
8. **DO NOT** use an extension cord with this appliance.
9. To protect against electric shock, **DO NOT** submerge the appliance or allow the power cord to contact liquid.
10. **DO NOT** allow the cord to hang over the edge of tables or counters, as it may become snagged and pull the appliance off the surface.

11. **DO NOT** allow the unit or the cord to come into contact with hot surfaces, including stoves and other heating appliances.
12. **ALWAYS** use the appliance on a dry, level surface.
13. **DO NOT** allow children under 8 years to operate this appliance. Close supervision is required when the appliance is used near children.
14. This appliance is **NOT** intended for use by individuals with reduced physical, sensory, or mental abilities or lack of experience and knowledge unless they are supervised or instructed by someone responsible for their safety.
15. Keep hands, hair, and clothing away from the container when loading and operating the appliance.
16. Avoid contact with moving parts during operation and handling of the appliance.
17. **DO NOT** microwave the containers or accessories provided with the appliance.
18. **ALWAYS** keep ventilation openings in the appliance or built-in structure clear of obstruction.
19. **DO NOT** use mechanical devices or other methods to accelerate the defrosting process unless recommended by the manufacturer.
20. **DO NOT** damage the refrigerant circuit. This warning applies only to appliances with accessible refrigerating circuits.
21. **DO NOT** use electrical appliances inside the food storage compartments unless recommended by the manufacturer.
22. **DO NOT** add solid items into the machine, such as ice cubes, frozen fruits, or frozen vegetables. Doing so may damage the machine and affect its proper functioning.
23. **DO NOT** add hot ingredients to the unit.
24. **DO NOT** submerge the motor base or control panel in water or other liquids.
25. **DO NOT** fill the vessel past the **MAX** line.
26. **NEVER** leave the appliance unattended while in use.
27. Before operation, ensure all utensils are removed from containers. Failure to do so may cause the containers to shatter, leading to injury or property damage.
28. **DO NOT** carry the unit by the bail handle. Hold the unit by grasping both sides under the motor base.

29. After unboxing the unit, allow it to remain upright for at least **4 hours** before operation to allow the refrigerants to settle in the air conditioning system for optimal performance.
30. Keep the appliance **10 cm (about 4 inches)** from other objects to ensure proper heat dissipation.
31. **DO NOT** use accessories not recommended by the manufacturer.
32. **DO NOT** use the appliance near flames, hot plates, or stoves.
33. Ensure at least a 5-minute interval between switching the power on and off to avoid damaging the compressor.
34. **DO NOT** use the appliance outdoors.
35. NEVER clean with scouring powders or hard implements.
36. Please keep the instruction manual for future reference.
37. To avoid contamination of food, respect the following instructions:
 - Opening the door for long periods can cause a significant increase in temperature inside the appliance.
 - Clean surfaces regularly that can contact food and accessible drainage systems.
 - Clean water tanks if they have not been used for 48 hours; flush the water system connected to a water supply if water has not been drawn for 5 days.
 - If the refrigerating appliance is left empty for long periods, switch off, defrost, clean, dry, and leave the door open to prevent mold.
38. **DO NOT** put your fingers into the discharge opening, as this may cause danger.
39. Ensure the appliance is positioned in a well-ventilated area to prevent overheating.
40. **DO NOT** store explosive substances such as aerosol cans with flammable propellants in the appliance.
41. **DO NOT** use electrical appliances inside the food storage compartments unless recommended by the manufacturer.

Risk of Fire or Explosion-Flammable Refrigerant Used

The refrigerant (R290) used in this appliance is flammable.



Caution: Risk of Fire / Flammable Materials

The appliance contains Propane (R290) in its refrigerant circuit, a natural gas with high environmental compatibility, but it is still flammable. During transportation and installation, take care to avoid damaging any components of the refrigerant circuit.

In the event of refrigerant circuit damage:

- Avoid open flames and sources of ignition.
- Ensure the room is well-ventilated.

Important Safety Guidelines

- DO NOT use mechanical devices to defrost the appliance.
- DO NOT puncture the refrigerant tubing.
- Servicing should only be performed by trained personnel.
- The appliance must comply with refrigeration system safety standards (ASHRAE 15) and should not be installed in public building corridors or hallways.
- Dispose of the appliance according to local or federal regulations, following all handling instructions to ensure safe disposal.

KEY COMPONENTS AND STRUCTURE

- ① Liquid Fill Lid
- ② Dispensing Handle
- ③ Liquid Container
- ④ Evaporator
- ⑤ Base
- ⑥ Condensation Catch
- ⑦ Control and Display Panel
- ⑧ Drip Tray Cover
- ⑨ Drip Tray
- ⑩ Liquid Container Lock/Unlock Handle
- ⑪ Mixing Fan Blade

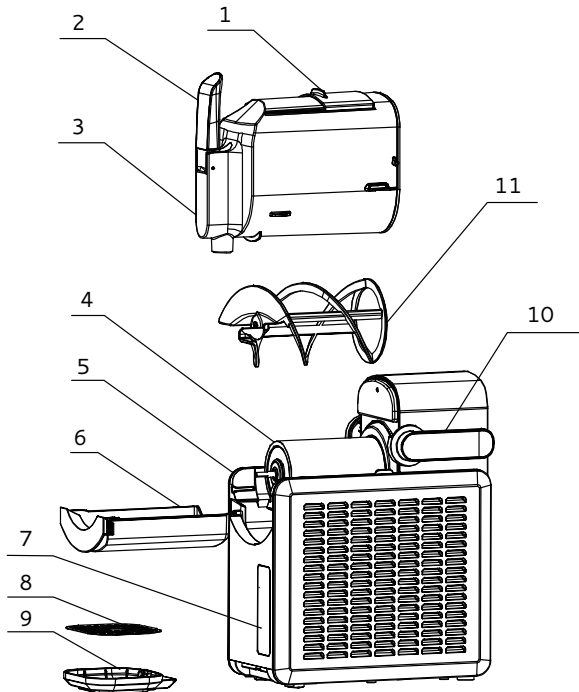

CONTROL AND DISPLAY PANEL

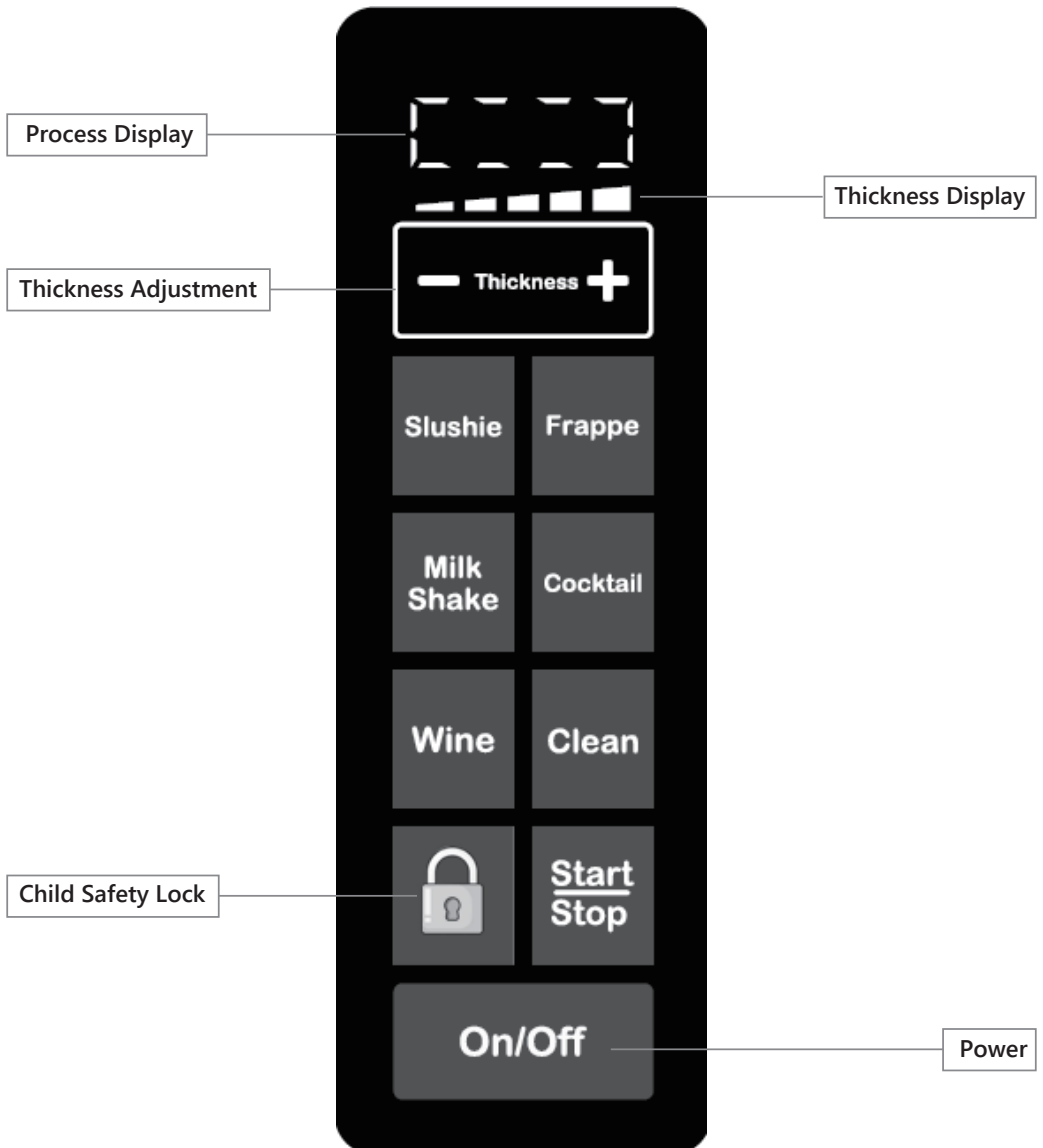

On/Off

Press to turn the unit on and off.

Start/Stop

Press to start or stop the process without turning off the unit.

Child Safety Lock

Locks the control panel to prevent accidental changes. It can be activated or deactivated with a specific sequence.

Clean

This cycle agitates the contents without cooling, allowing you to rinse the unit.

Presets (Slushie, Frappe, Milkshake, Cocktail & Wine)

5 preset drink options cater to different frozen drink preferences.

Thickness Adjustment

Each preset starts at a default/optimal thickness for the best texture. If needed, adjust the thickness for your perfect frozen drink consistency:

- For sippable frozen drinks, decrease the thickness by pressing the down arrow on the control panel.
- For thicker, colder frozen drinks, increase the thickness by pressing the up arrow on the control panel.

NOT ACHIEVING THE RIGHT SLUSH TEXTURE?

If your recipe hasn't reached the desired texture after 60 minutes, try increasing the thickness by one level. Wait for 10–15 minutes, then check the texture. If it's still not the desired consistency, increase the thickness by one more level and repeat this process until the perfect texture is achieved.

PRESETS

Each preset will start at a default/optimal thickness for the ideal texture. If desired, adjust the thickness to fit your perfect frozen drink texture.

PRESET	DESIGNED FOR	RECIPE EXAMPLES
SLUSHIE	Designed for creating icy, refreshing beverages.	Soda, Lemonade
FRAPPE	Perfect for coffee enthusiasts to make frosty, blended delights.	Coffee, Mocha
MILKSHAKE	Ideal for creamy, smooth, and indulgent dairy-based drinks.	Chocolate Milk, Banana Milk
COCKTAIL	Crafted for mixing alcoholic beverages into chilled, flavorful concoctions.	Martini, Margarita
WINE	Tailored for serving chilled wines with a perfect, refreshing twist.	White, Rosé

BEFORE FIRST USE

1. Remove all packaging materials from the unit.
2. Clean all parts that come into contact with water using warm water and a mild detergent.
3. Thoroughly rinse and air-dry all parts.
4. Wipe the control panel, motor base, and evaporator with a soft cloth. Allow them to dry completely before use.
5. Place the unit on a countertop and let it sit for at least **4 hours** before operating. This allows the refrigerant to settle in the condenser for optimal and safe performance.
6. Keep the appliance **10 cm (about 4 inches)** from other objects to ensure proper heat dissipation.

NOTE: *All attachments are BPA-free. Accessories are dishwasher safe but should NOT be cleaned with a heated dry cycle.*

HOW TO USE

IMPORTANT: Review all warnings at the beginning of this User Guide before proceeding.

First-Time Cleaning Before Use

Ensure the power cord plug is disconnected from the socket before cleaning.

Thoroughly wash and wipe all components that come into contact with liquid (e.g., evaporator, liquid container, mixing fan blade).

Always place the machine flat on a horizontal surface to ensure proper compressor operation.

Notes:

When using the device, ensure the liquid is at least at the **MIN** line.

DO NOT fill with liquid beyond the **MAX** line.

DO NOT add ice cubes or solid components such as fruits, ice cream, or vegetables.

If using juice with pulp, filter out the pulp before adding.

DO NOT add hot ingredients.

Following these guidelines will help ensure the safe and efficient operation of the device!

Installation Guide

1. Follow the image below to correctly attach the dispensing handle and position the drip tray, ensuring both are securely fastened and properly aligned.

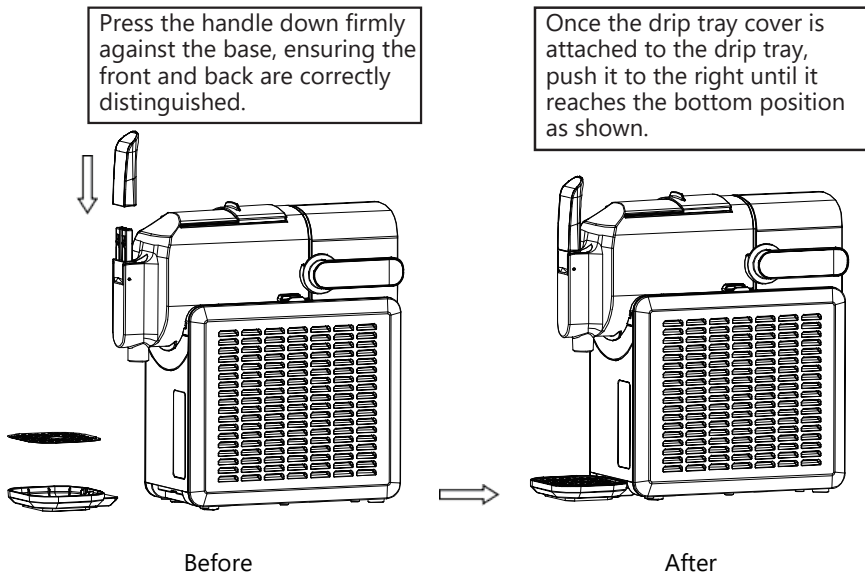

2. Before operation and dispensing, ensure the mixing fan blade and liquid container are assembled and locked in place, as shown in the figure.

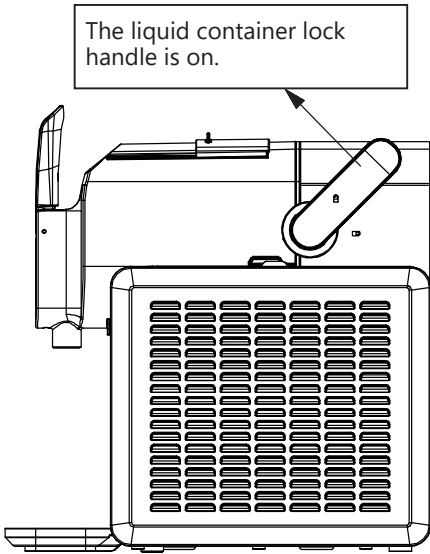

Before

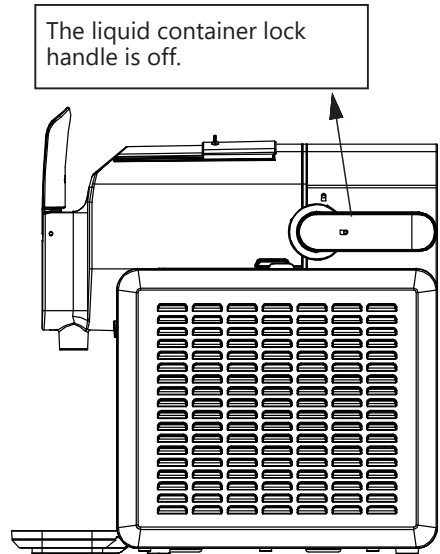

After

OPERATE THE FROZEN DRINK MAKER

1. Before pouring liquid into the charging container, ensure that the liquid container is installed correctly. (Refer to the "CLEAN & DISASSEMBLY" for disassembly and assembly steps.)

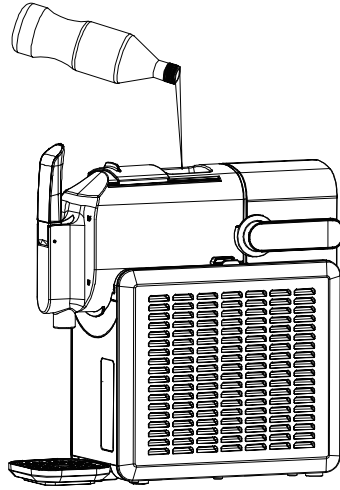

2. Open the top cover of the liquid container, then slowly pour the solution in, making sure the liquid level stays between the **MIN** and **MAX** lines.



3. Slide the top cover of the liquid container into place.

4. Plug in the power cord and press the **On/Off** button to turn on the machine. You will see 5 preset options and other function buttons.

5. Touch the corresponding preset program button (e.g., Slushie).

6. Use the “-” or “+” buttons to adjust the slush thickness. There are 5 levels: the higher the level, the lower the temperature, and the thicker the slush’s icy texture. The default thickness is set to level 3 during the first use. On subsequent uses, the machine will automatically select the last used setting.

7. Press the **Start/Stop** button to begin operation. The child safety lock will activate 10 seconds after starting, preventing operation while the indicator is lit. To deactivate the child safety lock, press and hold the icon for 3 seconds. The indicator light will go off, and the machine can then be operated.

8. To pause or resume the machine, press the **Start/Stop** button. To turn off the machine, press the **On/Off** button again.

9. Once the slush is ready, the buzzer will sound for 3 seconds, and **COOL** will appear on the display. The machine will then enter a keep-cool mode, maintaining the set thickness.

10. Place your cup under the dispensing handle, pull the handle, and enjoy your slush.

Protective Features

Motor Protection

The machine software monitors the operating state to prevent the motor from stalling due to increasing slushie stiffness. If necessary, it will automatically stop the motor to protect its lifespan.

Compressor Protection

To prevent frequent compressor restarts, the compressor has a 3-minute protection period. If the machine is turned on before 3 minutes have elapsed after the compressor has stopped, it will not start. However, the machine will start without delay if the power cord is unplugged for 20 seconds and plugged back in.

Liquid Container Fall Protection

The machine includes a safety switch that prevents operation if the liquid container is removed or falls off. The machine will not start, and the display will show “OPEN” to indicate that the container is not properly installed.

CLEAN & DISASSEMBLY

Clean Mode

To clean the machine, fill the liquid container with water up to the MAX line. Ensure the water temperature does not exceed 50°C (122°F). Turn on the machine and select the cleaning mode. The default cleaning time is 4 minutes.

After cleaning, drain the water from the container. You may repeat the cleaning process if the container is not thoroughly cleaned after one cycle.

Disassembly and Deep Cleaning

1. Disassembly

Before disassembly, pour clean tap water into the liquid container and run the cleaning mode for about 4 minutes. Then, discard the liquid in the container.

Disconnect the power, unlock and remove the liquid container, and then remove the mixing blade for cleaning and drying. Remove and clean the drip tray, then wipe the evaporator and rear seal ring with a clean towel, being careful not to remove or pull the seal ring to avoid damage.

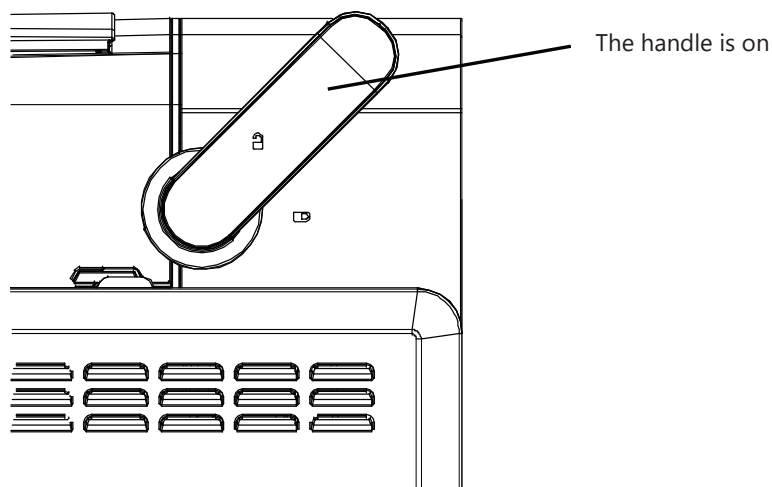

2.Cleaning All Parts

The liquid container, mixing blade, and water tank can be cleaned in a dishwasher. For hand washing: Prepare warm water (40-50°C) with mild detergent. Use the detergent to clean all parts that come into contact with the ingredients, then rinse them with running water. Use a soft brush to clean the seal ring at the back of the evaporator barrel, and finally, wipe the cleaned parts with a dry towel or air-dry the surfaces.

TIPS

1. DO NOT exceed the maximum capacity to avoid overflow. For accurate thickness control, ensure the ingredients reach at least the MIN line. For the best slush results, use the maximum capacity.
2. Time may vary depending on factors like temperature, ingredient warmth, sugar content, and hardness.
3. Ingredients must have >6% sugar content, and alcohol should be between 2%-16%. Using unsuitable ingredients may cause damage.
4. Pre-cooling ingredients can improve efficiency.
5. Filter natural juice to prevent clogging the dispensing outlet.
6. DO NOT stop the mixing motor during the program.
7. Condensation on the liquid container in humid weather or after prolonged use is normal.

RECIPE

Fizzy Fruit Punch Soda Slush

Ingredients

2-3 CUPS	4-6 CUPS	6-8 CUPS
2 cups of fruit juice	4 cups of fruit juice	5 cups of fruit juice
2 tbsps of honey or agave syrup (optional)	3 tbsps of honey or agave syrup (optional)	4 tbsps of honey or agave syrup (optional)
1 can of sparkling water or soda	2 cans of sparkling water or soda	3 cans of sparkling water or soda
Fresh fruit slices for garnish	Fresh fruit slices for garnish	Fresh fruit slices for garnish

Instructions

Pour soda and juice into the liquid container.

Select **SLUSHIE**. The Preset will start at the recommended thickness for ideal texture.

If desired, adjust the thickness.

Once the frozen drink reaches optimal thickness, the unit will beep.

Dispense and enjoy.

TIPS

- Diet soda (or soda made with sugar alternatives) will NOT work in this unit.
- For best results, chill liquid before adding to the unit.

*NOTE: For easier cleaning, **DO NOT** stop or turn off the preset until all frozen drinks have been dispensed.*

STRAWBERRY COFFEE FRAPPE

Ingredients

2-3 CUPS	4-6 CUPS	6-8 CUPS
2 cups of coffee	4 cups of coffee	6 cups of coffee
1 cup of strawberry juice	2 cups of strawberry juice	3 cups of strawberry juice
1/4 cup of vanilla syrup	1/3 cup of vanilla syrup	1/2 cup of vanilla syrup

Instructions

Pour the coffee and strawberry juice into the liquid container.

Select **FRAPPE**. The Preset will start at the recommended thickness for ideal texture.

If desired, adjust the thickness.

Once the frozen drink reaches optimal thickness, the unit will beep.

Dispense and enjoy.

MATCHA MILKSHAKE

Ingredients

2-3 CUPS	4-6 CUPS	6-8 CUPS
2 cups of whole milk	4 cups of whole milk	5 cups of whole milk
1 cup of heavy cream	2 cups of heavy cream	3 cups of heavy cream
2 tbsps of granulated sugar	3 tbsps of granulated sugar	4 tbsps of granulated sugar
1/4 cup of syrup	1/2 cup of syrup	1 cup of syrup
2 tbsps of matcha powder	3 tbsps of matcha powder	4 tbsps of matcha powder

Instructions

In a large bowl, whisk together all ingredients until combined and sugar, syrup, and matcha powder are fully dissolved.

Pour the mixture into the liquid container.

Select **MILKSHAKE**. The Preset will start at the recommended thickness for ideal texture. If desired, adjust thickness.

Once the frozen drink reaches optimal thickness, the unit will beep.

Dispense and enjoy.

MOJITO COCKTAIL SLUSH

Ingredients

2-3 CUPS	4-6 CUPS	6-8 CUPS
1/3 cup of mint simple syrup	2/3 cup of mint simple syrup	1 cup of mint simple syrup
3/4 cup of light rum	1 1/2 cups of light rum	2-3 cups of light rum
1 cup of lime juice, freshly squeezed, filter out all the pulp	2 cups of lime juice, freshly squeezed, filter out all the pulp	3 cups of lime juice, freshly squeezed, filter out all the pulp

Instructions

Pour syrup, light rum, and lime juice into the liquid container.

Select **COCKTAIL**. The Preset will start at the recommended thickness for ideal texture.

If desired, adjust thickness.

Once the frozen drink reaches optimal thickness, the unit will beep.

Dispense and enjoy.

Rosé Wine Slush

Ingredients

2-3 CUPS	4-6 CUPS	6-8 CUPS
2 cups of rosé wine 1 cup of lemonade or fruit juice 1 tbsp of honey or sugar (optional) Fresh fruit slices or mint leaves for garnish	4 cups of rosé wine 2 cups of lemonade or fruit juice 2 tbsps of honey or sugar (optional) Fresh fruit slices or mint leaves for garnish	5 cups of rosé wine 3 cups of lemonade or fruit juice 3 tbsps of honey or sugar (optional) Fresh fruit slices or mint leaves for garnish

Instructions

Pour wine and juice/lemonade into the liquid container.
 Select **WINE**. The Preset will start at the recommended thickness for ideal texture.
 If desired, adjust thickness.
 Once the frozen drink reaches optimal thickness, the unit will beep.
 Dispense and enjoy.

TROUBLESHOOTING

Problem	Possible Cause	Solution
Mixing fan blade scraping	Using ingredients with low sugar content may cause the evaporator to freeze, or setting the thickness too high may result in the slush being too hard.	Use ingredients with higher sugar content.
	Check that the mixing fan blade is properly assembled and not deformed.	Reassemble the fan blade correctly.
	The mixing fan blade is deformed.	Replace it with a new one.
Display shows "OPEN"	The liquid container is not assembled correctly, or the liquid container assembly does not make proper contact with the microswitch.	Reassemble the liquid container. Before reassembling, ensure the mixing fan blade is correctly assembled. Confirm the container is properly installed and the container switch is securely locked. If the issue persists after reassembly, please take the unit to a professional repair center for servicing.
Display shows "E1"	Sensor short circuit	Power off and unplug the unit. Wait for a moment before powering it on again. If the problem persists, please contact Euhomy service.
Display shows "E2"	Sensor open circuit	Power off and unplug the unit. Wait for a moment before powering it on again. If the problem persists, please contact Euhomy service.
Display shows "E3"	Motor stalled or faulty hall sensor	Power off and unplug the unit. Wait for a moment before powering it on again. If the problem persists, please contact Euhomy service.

SPECIFICATIONS

Specification	Volume
SKU	DM001-26BL-USEH
Model Number	ISM2621D
Effective Volume	2.6L
Usable Volume	1.9L
Voltage	AC110-120V /60 Hz
Power Consumption	220W
Protection Against Electric Shock	Class I
Climate Type	N/SN
Net Weight (N.W.)	10.5 kg (23.15 lbs)
Gross Weight (G.W.)	12.5 kg (27.55 lbs)
Maximum Overall Dimensions (L*W*H)	429*177*450mm (16.89*6.97*17.72 inches)
Packing Dimensions (L*W*H)	499*276*533mm (19.64*10.86*20.98 inches)

EÜHOMY

Live the *cool life*



support@euhomy.com



<https://euhomy.com>