

# Commercial Dehumidifier

## Instruction Manual

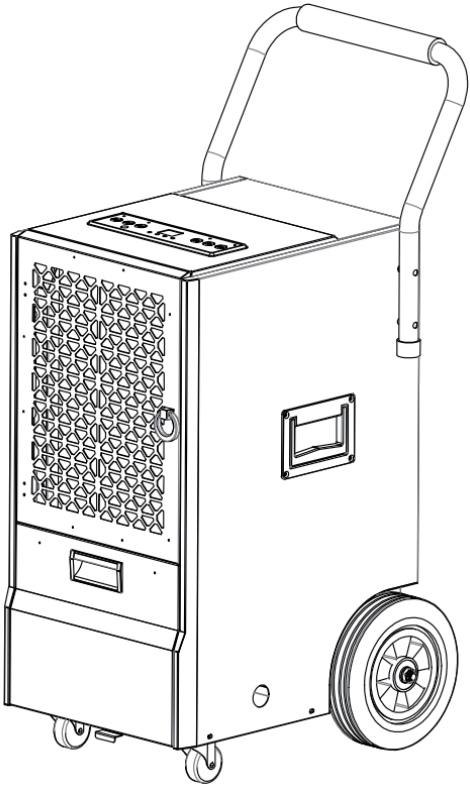

Model: OL50D-BDD056CE  
SKU:ZX-DH-01-AZ-HM

# Dear Customer:

Welcome to our family. Thank you for purchasing one of our products.

Our goal is to provide you with superior service. If there is anything missing from or wrong with your order, or if you have any questions about using our Dehumidifier, PLEASE contact us.

Email: [support@homyd.com](mailto:support@homyd.com)

Our team is available 24/7 to address your questions, comments, and concerns. Your satisfaction is our ultimate goal. We want to make everything right so you'll share your positive experience with other shoppers on Amazon.

If you experience any problems, please send an email to [support@homyd.com](mailto:support@homyd.com).

Our mission:

- \*To be the most trusted appliance brand.
- \* To create practical, compact appliances that better your life.

# Contents

IMPORTANT INSTRUCTIONS	2
PRODUCT DRAWINGS	3
INSTALLATION	4
MACHINE SETUP AND OPERATION	5-8
ERROR	9
MAINTENANCE	9-10
MACHINE STORAGE	11
TECHNICAL PARAMETERS	12
TROUBLE SHOOTING	13
WARRANTY AND SERVICE	14

# IMPORTANT INSTRUCTIONS

**Note: When using electrical appliances, please follow these basic precautions to reduce the risk of fire, electric shock, and personal injury or property damage. All refrigeration products contain refrigerants, which under federal law must be removed prior to disposal.**

1. Operate the unit from a power source of equal voltage, frequency, and rating as indicated on the product identification plate.
2. Extreme caution and supervision is necessary when unit is used near children and pets or when left operating while unattended.
3. Do not operate unit if cord/plug has been dropped or damaged in any manner.
4. Do not obstruct inlet or outlet openings. Do not operate in close proximity to walls, curtains, or other objects that may block inlet and outlet.
5. This unit must be plugged into grounded outlet.
6. To reduce the risk of electric shock, do not expose unit or power cord to moisture.
7. Always turn off and unplug unit prior to performing routine maintenance, or when not in use.
8. The use of attachments or accessories is not recommended or intended for use with product.
9. This product is intended for normal commercial use only.
10. Do not attempt to dismantle the appliance.
11. Do not operate unit on a metal surface.
12. Do not clean the appliance with any chemicals.
13. Unplug the power supply when cleaning or storing the unit.
14. This unit is not intended for hazardous locations.

# PRODUCT DRAWINGS

## 2.1 Front View

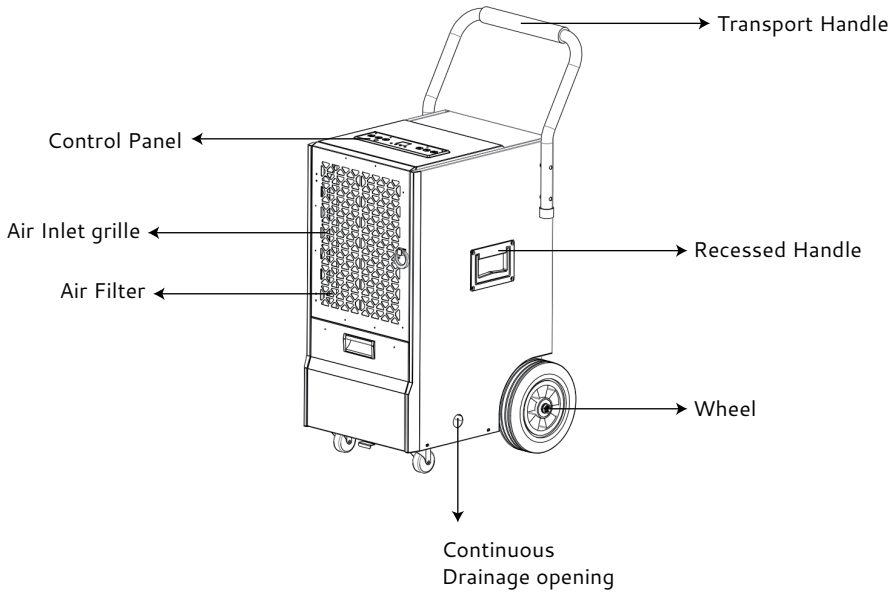

## Back View

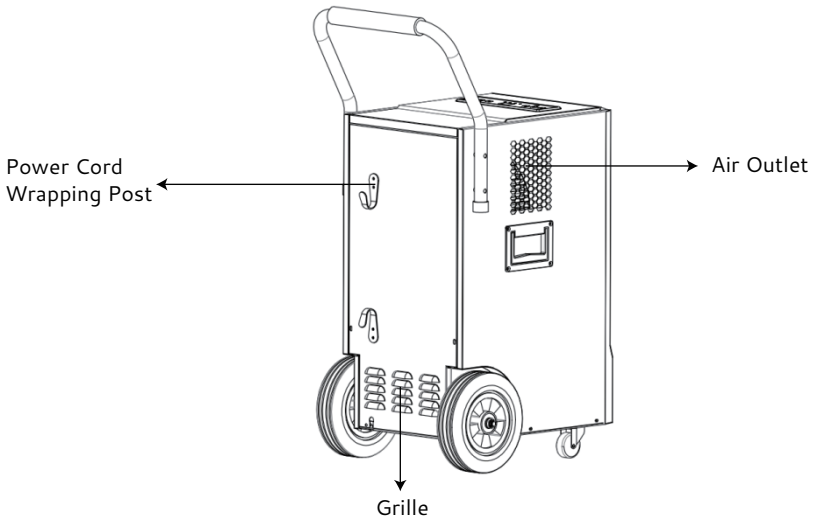

# I INSTALLATION

## 3.1 Handle and Support Frame Installation

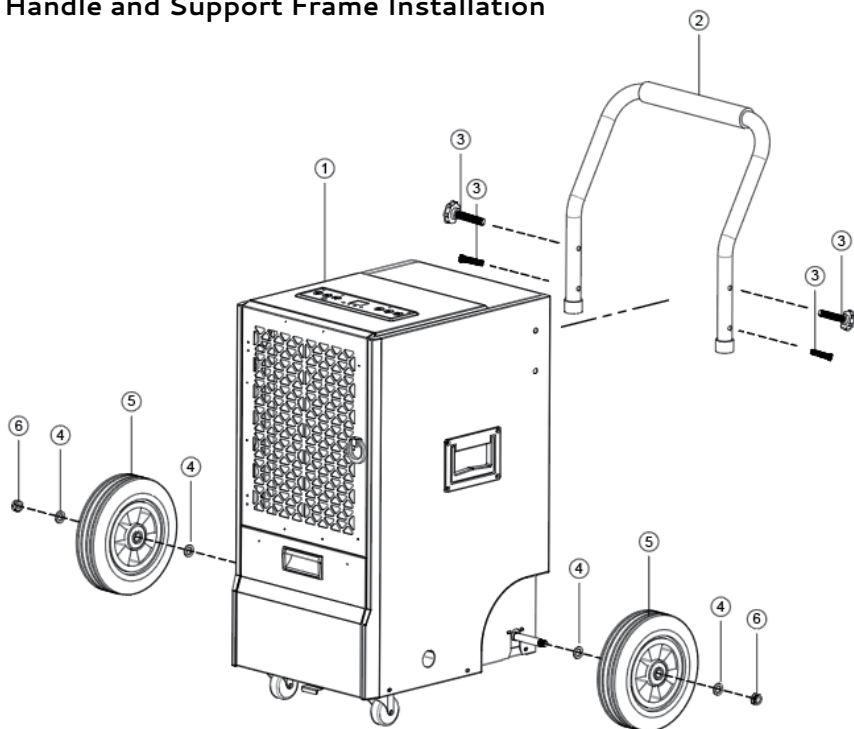

① Main Body

③ Stainless Steel Bolt

⑤ Wheel

① Push Handle

③ Flat Washer

⑤ Nut

# I MACHINE SETUP AND OPERATION

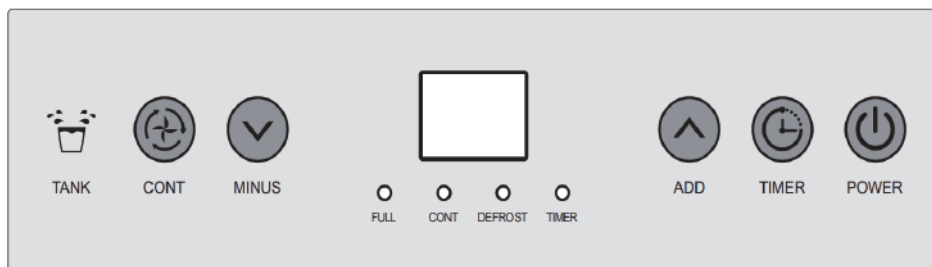

## 4.1 Button Function



(1) Press this button while on electric, screen light on, machine automatically goes to continuous drying mode, display screen shows environmental humidity, compressor on after the fan run for 3 seconds; press this button again, compressor stops, display screen become darker, but still show environmental humidity, machine goes into standby mode, the fan will run for another minute and stop.



(2) Press this button while machine is on electric (standby mode), until button light goes on, press "MINUS" "ADD" to set the time to start the machine, when the countdown is over, the fan and compressor turn on.

Press this button while machine is running, until the button light goes on, press "MINUS" "ADD" to set the time to stop the machine, when the countdown is over, the fan and compressor will shut off.

Press TIMER and POWER button together to show current temperature. After 10 seconds, the display will return to show current humidity.

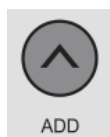

(3) The humidity can be increased by increments of 5%RH during normal mode. Hold this button for 1 second to increase the humidity continuously.



(4) The humidity can be decreased by increments of 5%RH during normal mode. Hold this button for 1 second to decrease the humidity continuously.

# MACHINE SETUP AND OPERATION

## Note:

1) The default humidity is 50%RH, to increase and decrease as follow:

20%-25%--30%-35%-40%45%-50%-55%-60%-65%-70%-75%-80%-85%-90%

2) Environmental humidity and machine set humidity will decide the status of the compressor and fan as follow:

Environmental humidity  $\geq$  machine set humidity+3%, compressor and fan start running.

Environmental humidity  $<$  machine set humidity+3%, compressor and fan stop running.



(5) During continuous mode, humidity setting is unavailable. Continuous mode light turns on and the screen will display the current humidity. Press this button to switch to normal mode where the humidity setting will be available.

## 4.2 Operation

1) When the water tank is full, the water tank light goes on red and alarm goes on after 5 seconds. The display will show "FL" error code and the compressor and fan shut off. After the water tank is emptied, the machine will automatically switch to the previous mode, the fan will start working, and compressor start working after 3 minutes delay.

2) Compressor will not need 3 minutes for self-protect if it was the first time to start the machine, press "POWER" and power off; power on, press "POWER", compressor starts immediately.

3) The system has auto memory. When all the mode setting has been finished, if there is sudden power cut during operation, or the power jack slips out, the system may store the current status before the power is cut and enter the operation mode before power cut automatically after power is supplied.

## 4.3 Defrost Function

1) The compressor and fan will shut off when the environmental temperature goes below 41 °F or above 100.4°F.

2) Defrost requirement: Compressor running for 30 minutes, temperature sensor sense the temperature  $\leq$  30.2°F, (last for 10 seconds), compressor stops, defrost starts, fan continues, defrost light turns on, when the pipe temperature goes to 41°F or the defrost last for 15 minutes, defrost stops.



# MACHINE SETUP AND OPERATION

**Note:** During defrost, light won't be off until the defrosting is over.

## 4.4 DRAINAGE

There are two ways of removal collected water produced by the unit.

- A. Manual draining: Empty water tank by manual.
- B. Continuous draining: Use gravity to drain condensate water by attaching a drain hose.

### 4.4.1 EMPTYING THE WATER TANK

The water tank built in unit will fill up and shut the unit down once it is full. It will run again once you empty the water tank and installed properly.

- 1) When the tank is full, the "FULL" light will turn on and display show "FL" error code.
- 2) The unit will make a buzzing sound. Press the power button to turn off the machine.
- 3) To empty the water tank, open the front panel to access the water tank.
- 4) Grab the handle of the water tank and pull it out horizontally.
- 5) After disposing of the water, replace the tank and close the front panel.
- 6) Press the POWER button to resume operation.

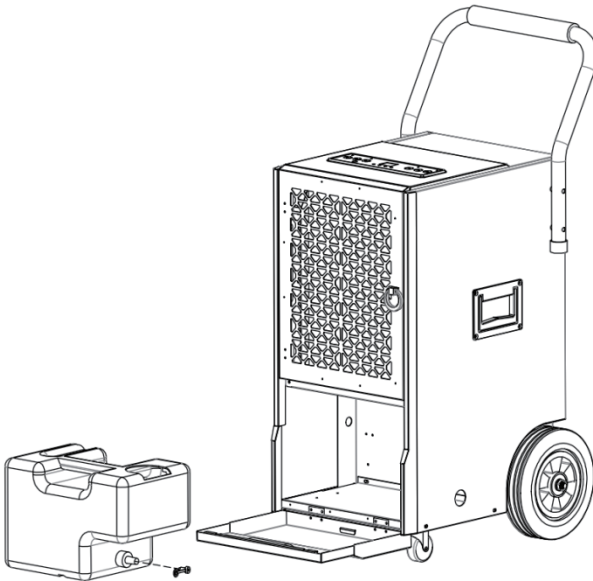

# MACHINE SETUP AND OPERATION

## 4.4.2 CONTINUOUS DRAINING

For continuous operation or unattended dehumidification, please connect the attached drain hose to the unit.

1. Press the POWER button to turn off the machine.
2. Open the front lower cover; remove the water tank from the unit.
3. Push the drain hose through the continuous drainage opening and connect one end to the hose connection.
4. Refit the water tank in the unit and close the front lower cover.
5. Direct the other hose end to the desired area. Make sure the drain hose is not kinked or bends. Remove the hose and seal the hose connection off with the plug if you want to collect the water in the water tank again. Allow the hose to dry prior to storage.

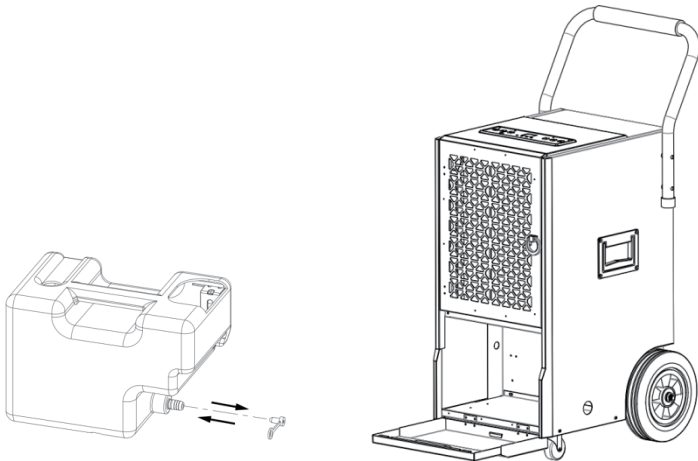

### WARNING:

**Do not block the drain hose, water will not drain properly and could damage components of the unit.**

# ERROR

- (1) "E1": If the copper pipe temperature sensor got failure, it will show "E1". The system works in cycles of dehumidification for 30 minutes and defrosting for 15 minutes. Failure temperature sensor should be replaced with a new one.
- (2) "FL": Water tank full, customer need to clear the tank and unit will work again.
- (3) "E2": Environmental temperature sensor broken, need to replace with a new sensor.

# MAINTENANCE

## CLEANING THE AIR FILTER (every two weeks)

The air filter is removable for easy cleaning. Do not operate the unit without an air filter, or the evaporator may be contaminated.

1. Clean the machine with a soft wet cloth.
2. Pull out the louver on the front panel to gain access to the filter.
3. Remove the filter mesh from the unit.
4. Use a clean rag to absorb the surface dust on the filter mesh. If the filter is extremely dirty, use tap water to flush the filter. Fully dry the filter before putting it back into the air inlet fence. A clean filter will increase the machine's capacity.

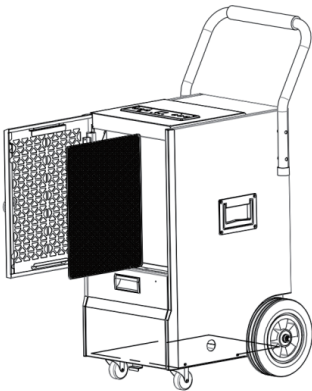

Pic1. Switch off the unit and remove air filter.

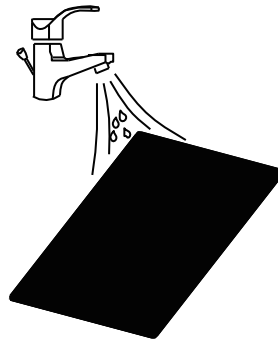

Pic2. Rinse the air filter under running water.

# MAINTENANCE

## CLEANING UP OF REFRIGERANT

### General Measures:

1. Gas/vapor heavier than air. May accumulate in confined spaces, particularly at or below ground level.
2. Eliminate every possible source of ignition.
3. Use appropriate personal protection equipment (PPE).
4. Evacuate unnecessary personnel, isolate, and ventilate area.
5. Do not get in eyes, on skin, or on clothing. Do not breathe vapors or gas.
6. Prevent entry to sewers and public waters.
7. Stop the source of the release, if safe to do so. Consider the use of water spray to disperse vapors.
8. Isolate the area until gas has dispersed. Ventilate and gas test area before entering. Contact competent authorities after a spill.

# I MACHINE STORAGE

If you don't use the unit for an extended period of time, please store it per the following steps:

(1) Clean the filter mesh.

**(2) ATTENTION:** The evaporator inside the machine has to be dried out before the unit is packed to avoid component damage and molds. Unplug the unit and place it in a dry open area for days to dry it out. Another way to dry the unit is to set the humidity point more than 2% higher than the ambient humidity to force the fan to dry the evaporator for a couple of hours.

(3) Store the power cord pocket at the back of unit.

(4) Store in a clean, dry environment.

# I TECHNICAL PARAMETERS

SKU	ZX-DH-01-AZ-HM
Power Supply	115V~60Hz
Dehumidifier Capacity	45Pints/D(65°F/60%RH) 70Pints/D(80°F/60%RH) 120Pints/D(86F/80%RH)
Rated Input Current	5.8A (80F/60%RH)
Gross Weight	89.1lb
Net Weight	76.6lb
Dimension	16.3*21.3*34.6in

# I TROUBLE SHOOTING

Please confirm by after-sale service for the following conditions.

Trouble	Cause	Solution
Machine does not run	Unit is not plugged in.	Plug in the unit.
	Room temperature under 41 °F or above 100.4°F.	To protect the machine, use it only when ambient temperature is between 41°F and 100.4°F.
Machine runs but does not dehumidify	When the humidity set point is 2% higher than ambient humidity.	Reset the humidity to a lower set point, or power off the machine if the humidity has satisfied you.
Reduce dehumidifier capacity	Filter mesh jammed.	Clean the filter mesh according to manual.
	Air-in and/or Air-out louvers jammed.	Clear the blockage from Air-in and/or Air-out louvers.
No air inlet	Filter mesh or air-in louver jammed.	Clean filter according to instructions or clean the louver blockage.
Loud Operation	Machine situated on an incline or decline slope.	Move to flat ground.
	Filter mesh jammed.	Clean filter mesh according to instructions.

**Cautions: Switch off the unit and unplug it immediately if anything abnormal happens. Then contact a qualified personnel.**



**Do not dispose of electrical appliances as unsorted municipal waste, use separate collection facilities.**

**Contact your local regulation for information regarding the collection systems available.**

# WARRANTY AND SERVICE

## WARRANTY AND SERVICE

This product is covered by a 12-month product and warranty from the date of initial purchase in case of any problems, please contact the Customer Service Center via the contact information listed in this User Guide.

Our warranty covers replacement products by repairing or replacing any defective parts and labor necessary to bring it up to its original specifications, and we can provide a replacement product instead of repairing the defective product. Our sole obligation under this warranty is limited to such repair or replacement.

Any claim will require a receipt showing the date of purchase, so please keep all receipts in a safe place. While greatly appreciated, product registrant is not required to activate any warranty and product registration does not eliminate the need for proof of original purchase. The warranty will be voided if repairs are performed by a non-authorized third party and/or if spare parts other than those provided by us are used. These are the general terms of our warranty service, but we always urge our customers to contact us ([support@homyd.com](mailto:support@homyd.com)) with any questions they may have, regardless of the terms of the warranty.